

Component Placing, Electrical

Applicable for W760

Contents

1	Mounting drawing table	2
2	Mounting drawing.....	3
3	Revision history.....	6

1 Mounting drawing table

Board Number	Drawing	Comments
NA	NA	Different W760 variants have different component placing drawings, but the reparable components are in the same positions on all drawings and PCBs. The W760c variant does not include N1210.

By using the “Search” function and entering the component name you can find the position of the component
(Use Adobe Reader 7.0 or a later version). Example: You can see the component name highlighted on the circuit board (use zoom to enlarge).

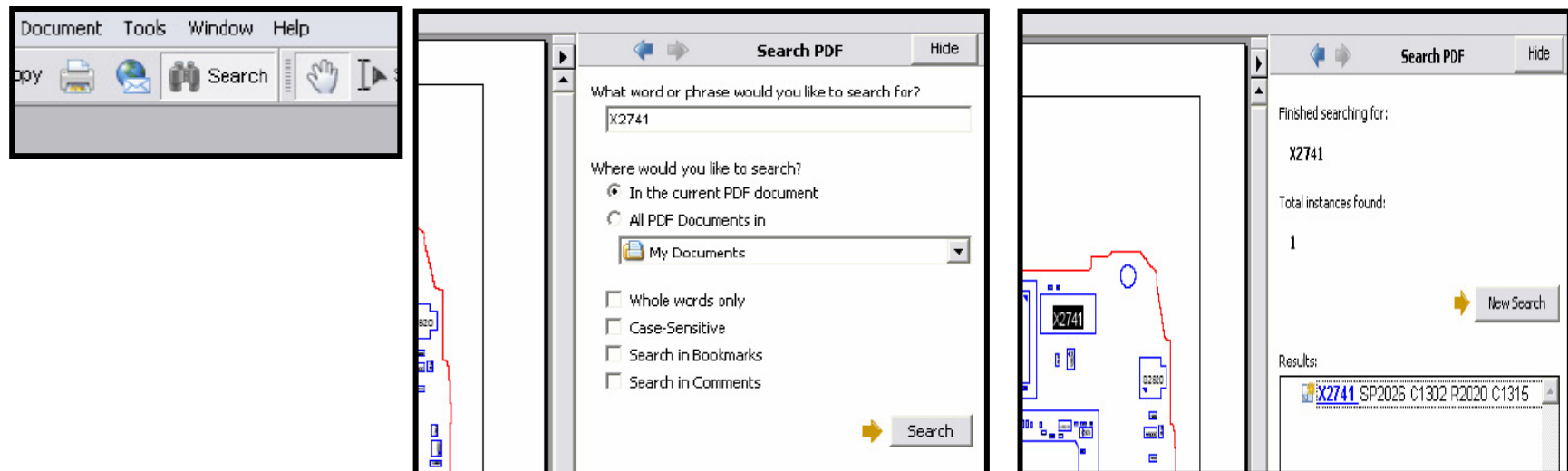

2 Mounting drawing

Primary Side

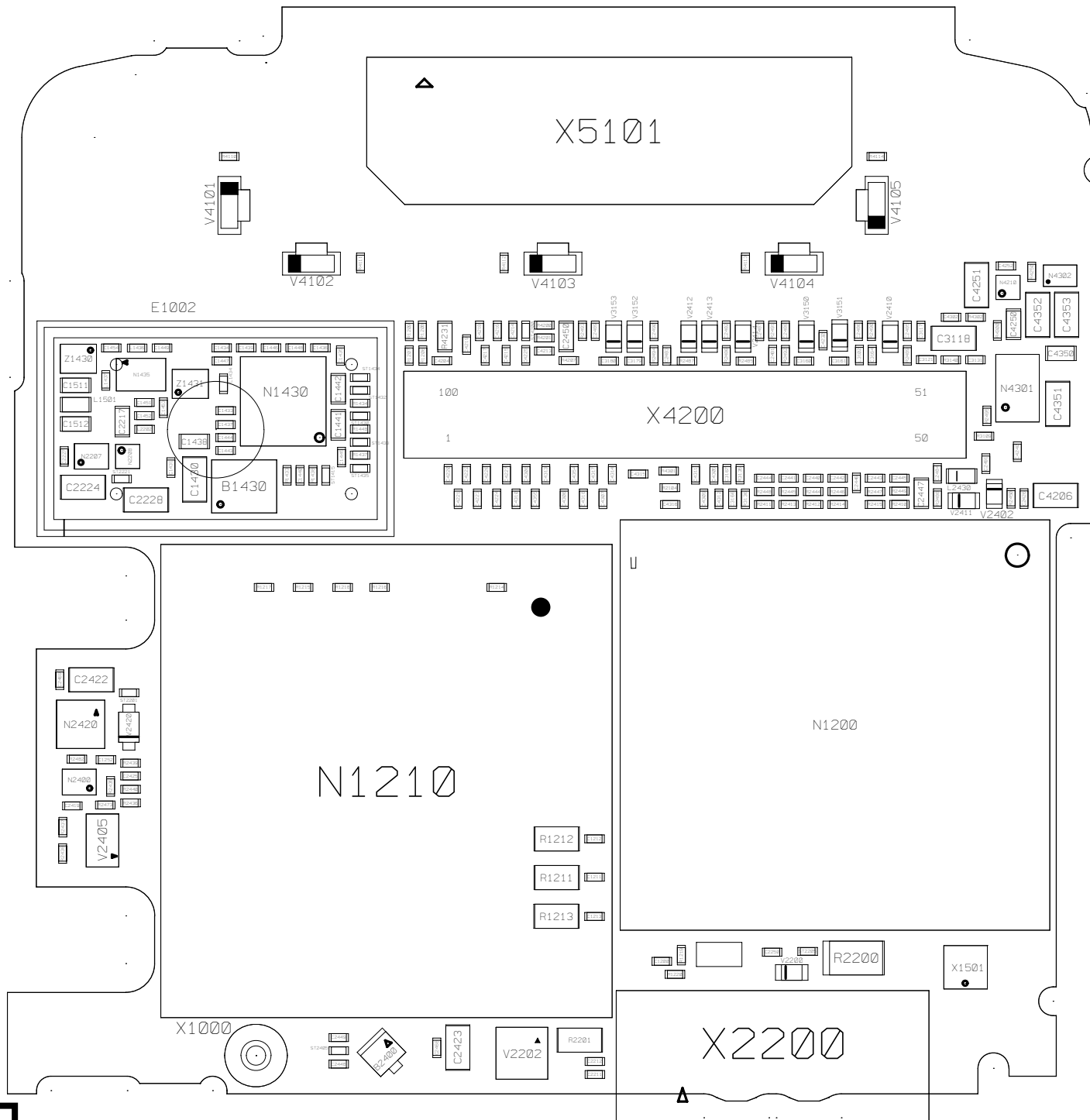

Secondary Side

BOTTOM COMPONENT
D2000
TOP COMPONENT
XD2000

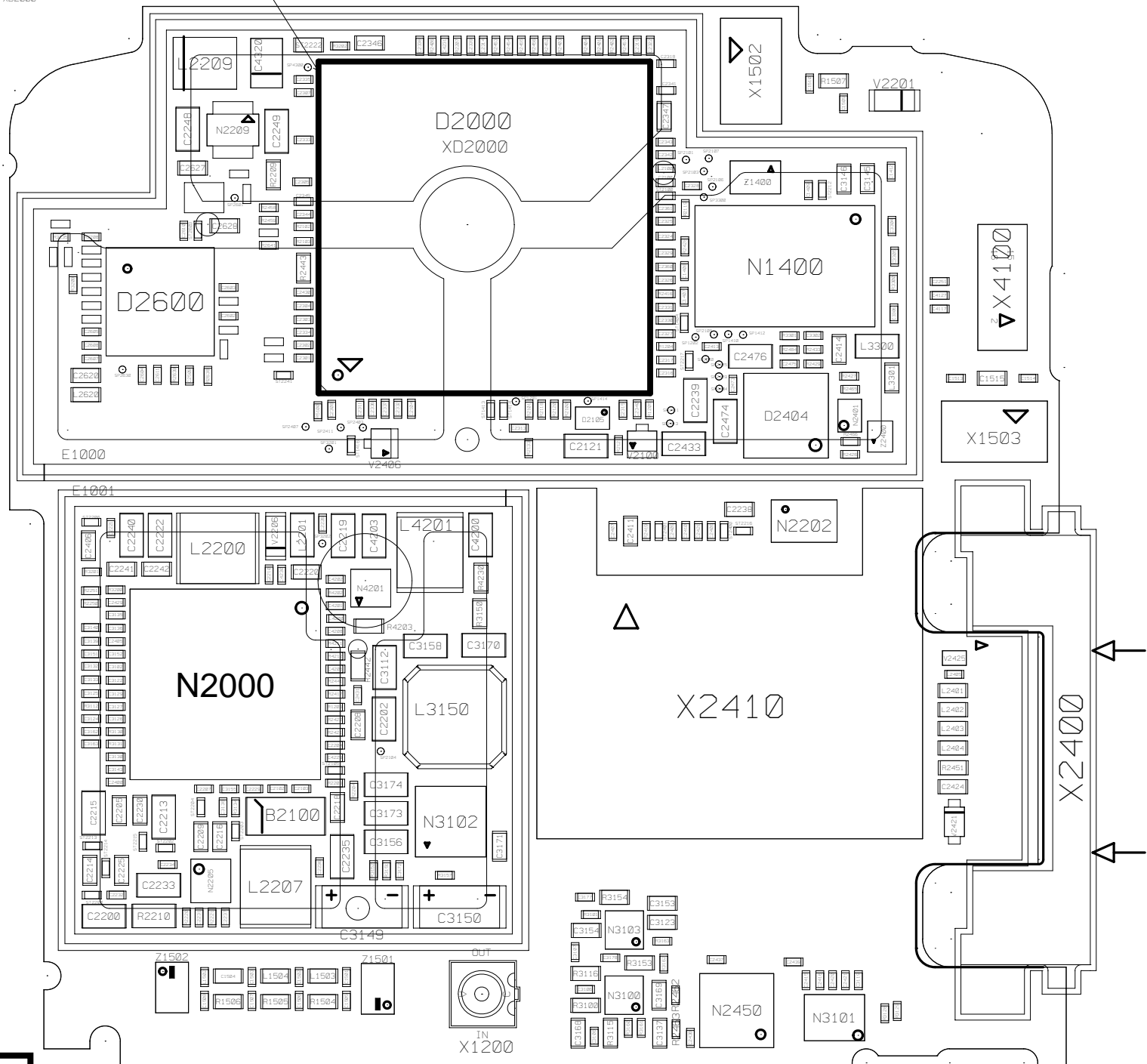

3 Revision history

Rev.	Date	Changes / Comments
1	2008-May-05	Initial Release